

GMR ALBA - LED

Notice d'installation

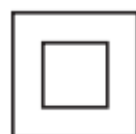

220 - 240 V
AC

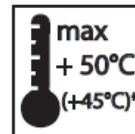
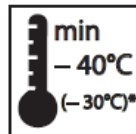

L'installation doit être réalisée par du personnel qualifié.

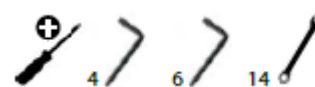

Pour toute question : 04 42 24 42 41
contact@jclighting.com
www.jclighting.com

Dimensions ALBA 2500



Scx : 0,09m²

Poids maxi : 8 Kg

ALBA 2600

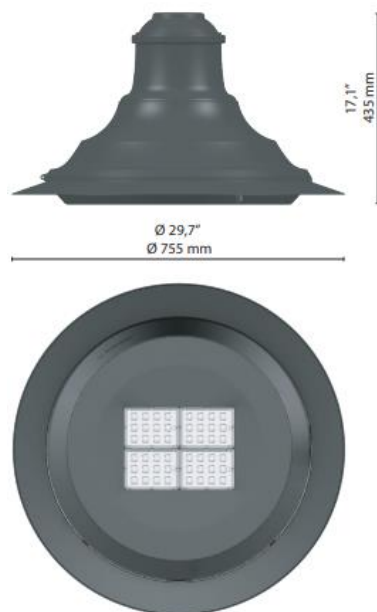

Scx : 0,12m²

Poids maxi : 15 Kg

Montage

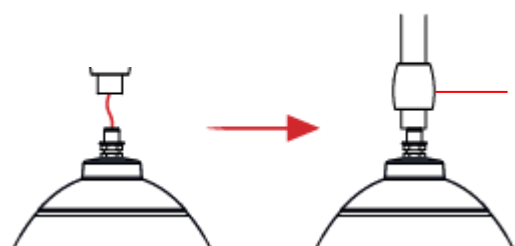

$\frac{3}{4}$ Gas longueur
50mm

Cache écrou
Rondelle et contre-écrou
inox

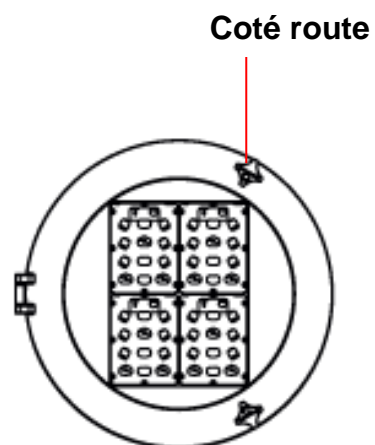

Montage suspendu $\frac{3}{4}$ Gas

OUVERTURE PAR LE BAS SANS OUTIL

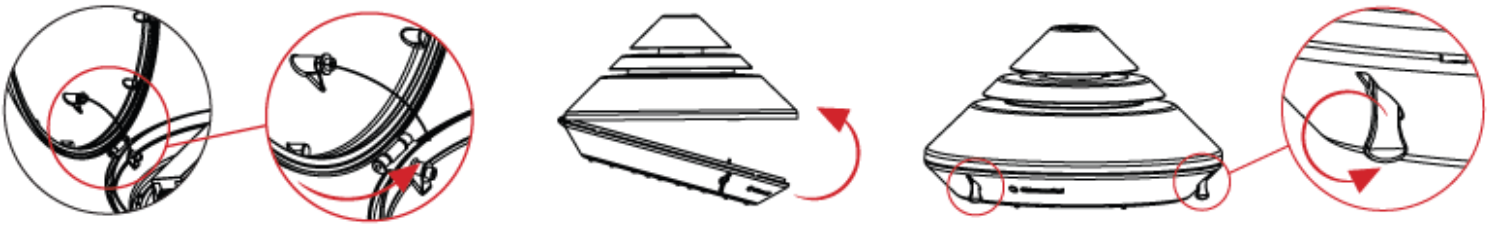

Vis de fermeture coté route

Passage du câble d'alimentation

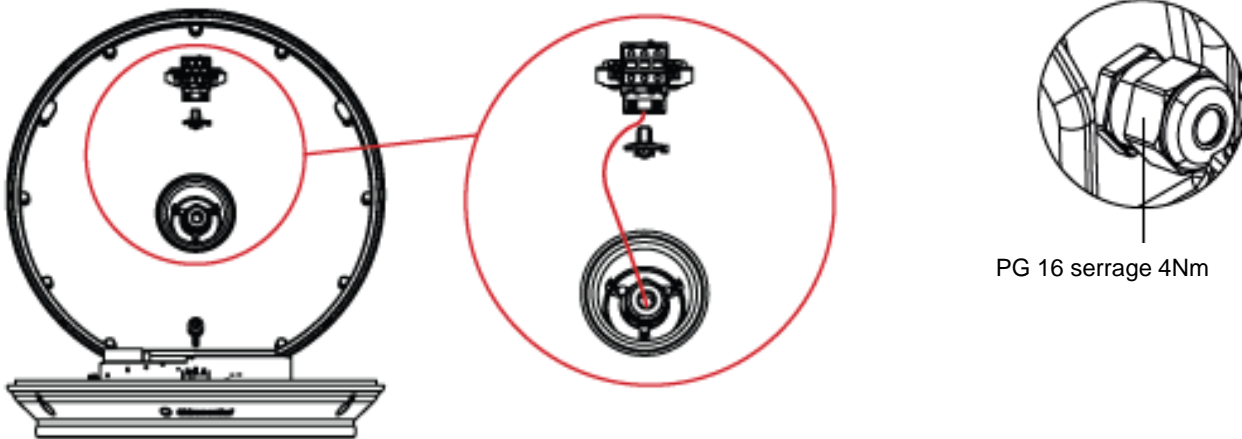

PG 16 serrage 4Nm

Raccordement Classe II - Dali

Utiliser exclusivement du câble HO7 RNF

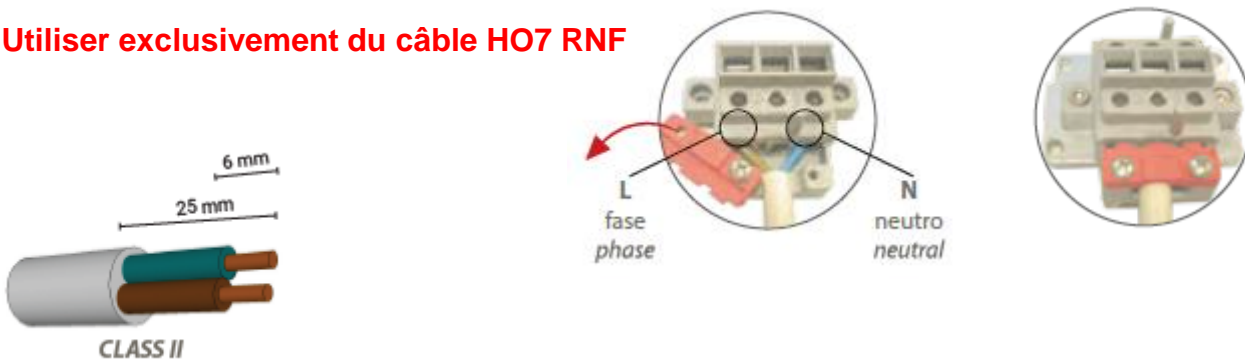

	Nombre de luminaire par Type de Disjoncteur										
	Courant d'appel En Ampère	Temps micro-seconde	Courbe B			Courbe C			Courbe D		
			10A	16A	25A	10A	16A	25A	10A	16A	25A
GL02 - 8 LED 350mA	25	236	12	20	32	20	33	52	47	81	100
GL02 - 8 LED 525mA	25	236	12	20	32	20	33	52	47	81	100
GL02 - 8 LED 1050mA	25	236	12	20	32	20	33	52	47	81	100
GL04 - 16 LED 350mA	25	236	12	20	32	20	33	52	47	81	100
GL04 - 16 LED 525mA	25	236	12	20	32	20	33	52	47	81	100
GL04 - 16 LED 1050mA	32	355	12	20	32	20	33	52	47	81	100
GL06 - 24 LED 350mA	32	355	6	10	16	10	16	26	22	37	72
GL06 - 24 LED 525mA	32	355	6	10	16	10	16	26	22	37	72
GL06 - 24 LED 1050mA	42	238	6	10	16	10	16	26	22	37	72